

size	2
type	Passive friction (F)
mounting type	Foot mounted bearing (F)
lowering rot. dir.	Clockwise (C)
reaction pos.	(2)
driving	Torque flange (F)
motor pos.	(1)
load recovery	x
recovery pos.	x

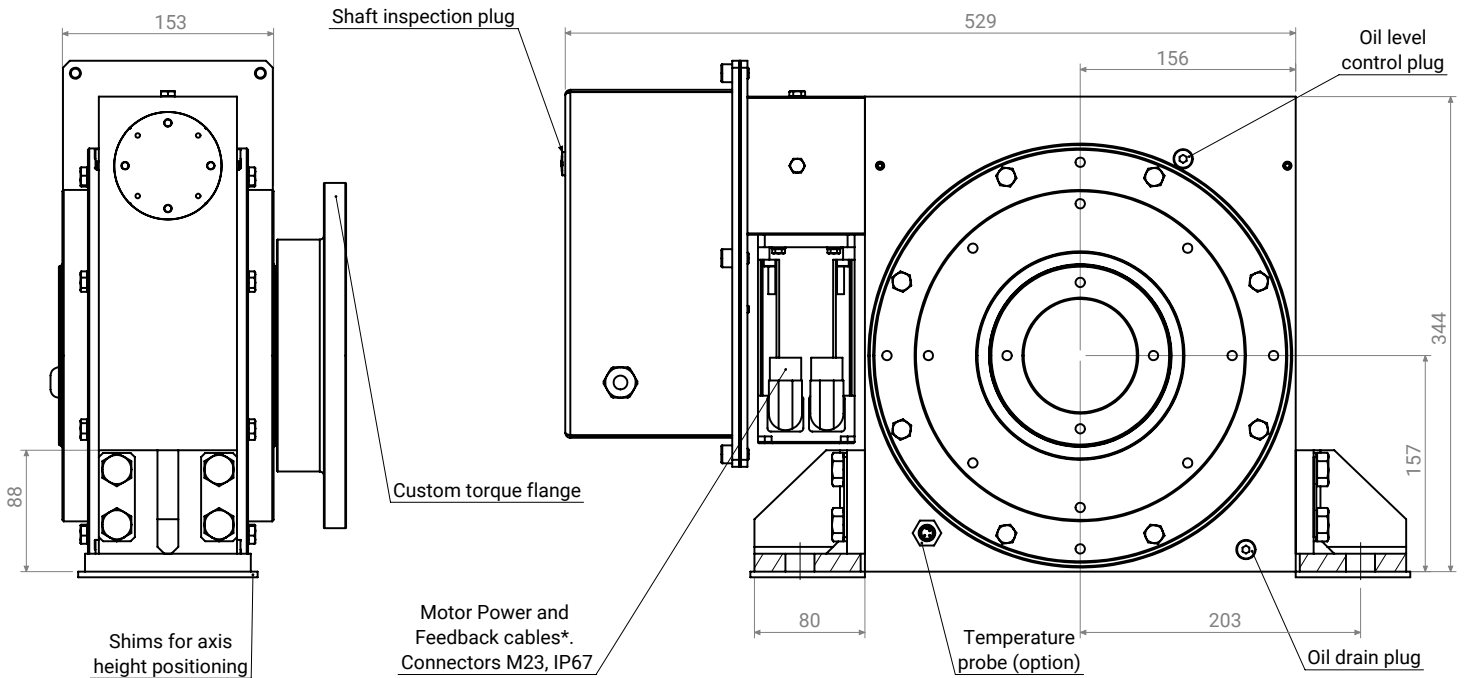

Arrest torque calculation
 $C_{MS} \geq 1.4 \times C_S$
 (C_S : Static torque at the hoist drum)

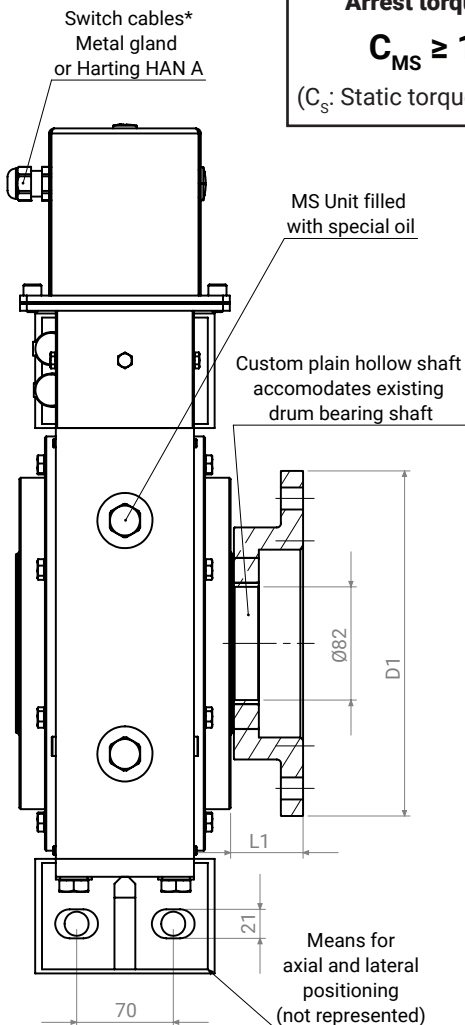

Max. arrest torque** (C_{MS})	Nm	12,600
Max. drum speed	rpm	66
Worm / worm wheel ratio		45
IP rating		IP65
Operational ambient temp. limit		-10°C
Servomotor power supply options		400VAC, three phases 230VAC, single phase 48VDC

Dimensions
L x W x H = 529 x 153 x 344 mm

Max. weight (this configuration)	kg	110
Oil volume	L	1.3
Control cabinet dimensions	mm	400 x 400 x 200

Torque flange

D1	mm	Custom
L1	mm	Custom

Drum bearing

Vertical capacity (up&down)	N	101,000
Horiz. lateral capacity	N	50,500
Horiz. axial capacity (locating)	N	20,200
Angular accomodation	°	±3

Mounting studs

Quantity		4
Size		M16

* All cables go to MotoSuideur control cabinet
 ** for required C_{MS} lower than 6,100 Nm, consider MS1F Unit models.